

7.95 to 8.55 GHz 10 Watt LT-PD Series 2-Way Power Divider

Our Product Introduction

Basic Information

- Place of Origin: CHINA
- Brand Name: ZR Hi-tech
- Model Number: LT-PD-2S-079085
- Minimum Order Quantity: 1
- Packaging Details: carton packing
- Delivery Time: 4 weeks
- Payment Terms: D/A,D/P,T/T



LT-PD-2S-079085

Product Specification

- Highlight: 8.55 GHz Power Divider

Product Description

7.95 to 8.55 GHz 2-Way Power Divider

Quick Detail:

- 2-Way Power Divider
- Stripline Design
- -40°C~+70°C operating temperature
- 7.95 to 8.55 GHz Frequency Range
- Max Power 10 Watt
- Insertion Loss < 0.4 dB
- Isolation > 25 dB
- CE, RoHS, REACH compliant
- 1 Year Warranty

Description:

The LT-PD-2S-079085 from ZR is a 2-way power divider that operates from 7.95 to 8.55 GHz and can handle up to 10 Watt (CW) with 0.4 dB max insertion loss and 25 dB min isolation. The package interface uses SMA-Female connectors and is REACH and RoHS compliant. More details for LT-PD-2S-079085 can be seen below.

Specifications:

Electrical / Optical Characteristics (Ta=25°C±3°C)

Items	Specification	Conditions
Part Number	LT-PD-2S-079085	
Frequency Range	7.95 to 8.55 GHz	
Impedance	50 Ohms	
Input VSWR	1.2:1 Max.	
Output VSWR	1.2:1 Max.	
Insertion Loss	0.4 dB Max.	Excluding Nominal Splitter Loss 3.0dB
Isolation	25 dB Min.	
Amplitude Balance	0.4 dB Max.	
Phase Balance	4 Degrees Max.	
Input Power	10 kW	
Connectors	SMA-Female	
Dimension	24x30x10 mm	

Note: for custom specs, please contact us directly.

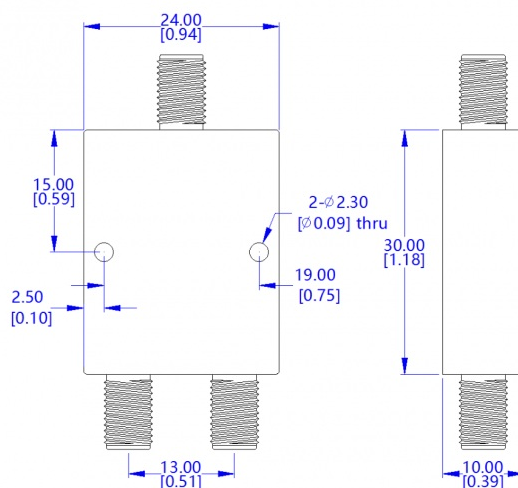

Outline Drawing (Unit: mm):